

Leading the way in cable trunking

For all products and sales...

call 01793 611777

fax 01793 615500



Chequer Plate Trunking

When a flush floor trunking is required in an area where excessive loads will be transported such as a warehouse or industrial environment, Flytec manufacture a robust steel trunking body fitted with a 6mm thick chequer plate lid fixed into place by M6 countersunk screws.



Trunking

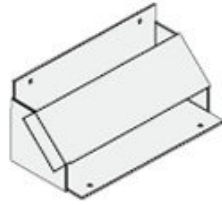

Riser Bend



Stop end



Flat Bend

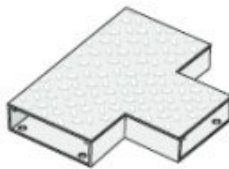

Tee

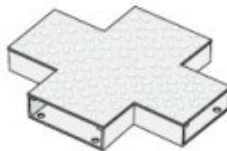

Crossover

- Single or multi-compartment options are available with a range of accessories.
- Because of the unique properties of this system to the installer, Flytec can make to order virtually any size of trunking and compartment configuration. Please contact us with your requirements.
- We recommend that Flytec flush floor trunking is installed on a ribbon screed or similar to ensure support along the entire length and width of the system.
- It is advisable that all lid sections are fitted during screeding. This will prevent any slight inward movement to the sides of the trunking body

Please note: Service boxes are not available with chequer plate trunking